

80013289
STANDARD

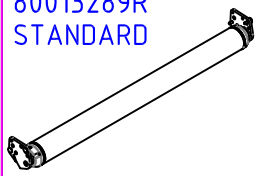

PROFESSIONAL BACK ROLLER

80013656
OPTIONAL



PROTECTION CHAIN

00025545
540rpm DX

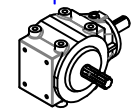

00021522
1000rpm DX

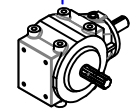

OPTIONAL

00021543
1000rpm SX

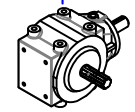

00021967
DYNAMIC

00021968
COMFORT

80013661
STANDARD

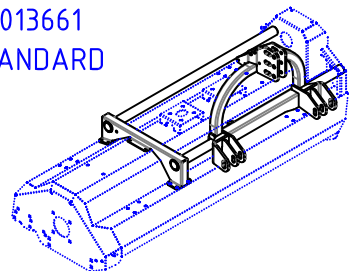

MECHANIC SIDE SHIFT

80013673
OPTIONAL

HIDRAULIC SIDE SHIFT

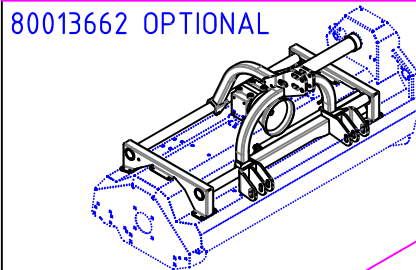
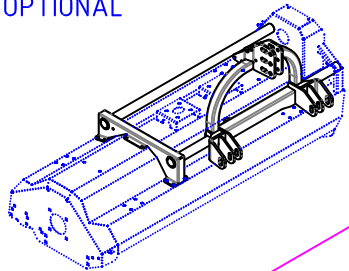

CENTRAL GEAR BOX
80012426 OPTIONAL

80012727
OPTIONAL

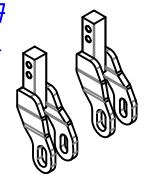

3 POINT LINKAGE LOWERING KIT

SKIDS

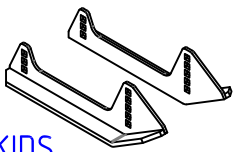

80013666
OPTIONAL

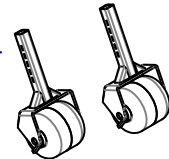

LITTLE FRONT WHEELS



00021988 DYNAMIC
AGROMECC

00021989 COMFORT
AGROMECC

80009951
OPTIONAL

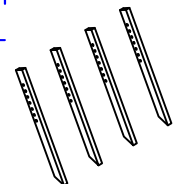

RAKES

80013832
OPTIONAL SOLO DYNAMIC

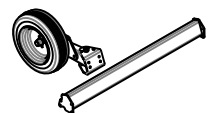

WHEELS

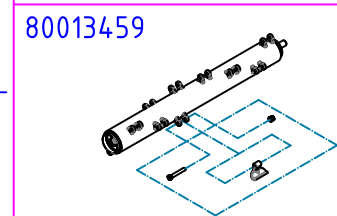
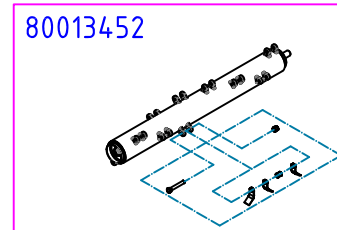
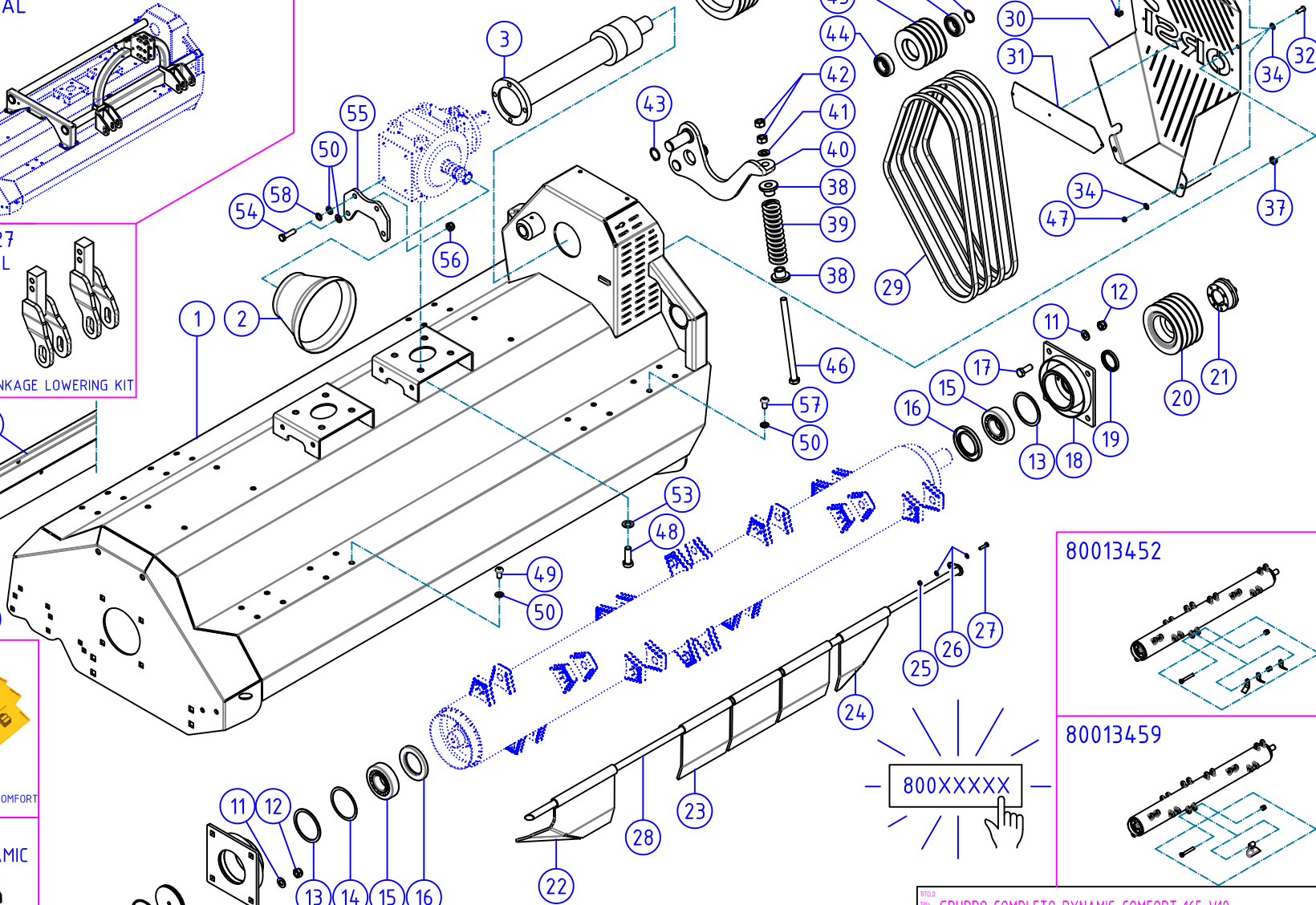

800XXXXX

GRUPPO COMPLETO DYNAMIC-COMFORT 165 V19		
CODICE 80014183	REV	DATA 07/07/2020



Codice / Code	80014183	GRUPPO COMPLETO DYNAMIC/COMFORT 165 V19
Data / Date	07/07/2020	Pagina / Page 1

Nr.	Codice Code	Descrizione Part	Quantità Quantity
1	30041314	CASSA DYNAMIC 165	1,00000
2	00019505	CONTROCUFFIA D=200 H=150	1,00000
3	00025585	PROLUNGA T-312B L= 615	1,00000
4	00018019	PULEGGIA 4 G.SPB D.200 F.80	1,00000
5	00018018	CALETTATORE D. 40 x 80	1,00000
6	10201000	SEEGER I100 U7437 NOR	1,00000
7	00011502	GUARNIZIONE OR 4375	1,00000
8	30012050	RONDELLA DI TENUTA SI-ST	1,00000
9	00027383	VITE UNI 5731 M14X35 8.8 ZIN.	4,00000
10	30012040	SUPPORTO L.RIN.SERIE SI-ST	1,00000
11	11140000	ROS.PIANA D.14 U6592 ZIN	8,00000
12	10114141	DA BASS.M 14 U7474 FE ZIN	8,00000
13	00012005	SPESSORE SERIE SI-ST 85X99X3	2,00000
14	00012008	SPESSORE SERIE SI-ST 85X99X1	1,00000
15	00011109	CUSCINETTO 21309 DOPPIA FILA RULLI SFERICI	2,00000
16	00012001	PARAOLIO 65x100x10	2,00000
17	11114091	VTE 14X 35 U5739 8.8 ZIN	4,00000
18	30008850	SUPPORTO L.PUL.SERIE SI-ST	1,00000
19	00012016	PARAOLIO 45x60x 7	1,00000
20	00018001	PULEGGIA 4 G.SPB D.140 F.80	1,00000
21	00018010	CALETTATORE D. 45X 80	1,00000
22	30040375	BANDELLA L.182/229 GS	1,00000
23	30038595	BANDELLA L.182 PRIMATIST PLUS	6,00000
24	30040374	BANDELLA L.200 GS	1,00000
25	10114061	DA BASS.M 6 U7474 FE ZIN	1,00000
26	11060000	ROS.PIANA D. 6 U6592 ZIN	2,00000
27	11106071	VTE 6X 25 U5739 8.8 ZIN	1,00000
28	30038498	ASTA PORTA BANDELLE PRIMATIST PLUS 165	1,00000
29	00010524	CINGHIA QPIII XPB 1500/5VX 595 (GATES)	4,00000
30	30041336	CARTER CINGHIE DYNAMIC	1,00000
31	01017801	PANTOGRAFATO DIETRO LOGO	1,00000
32	11908071	VTBE 8X 25 I7380 10.9 ZIN	7,00000
33	12080000	ROS.GROW. D. 8 U1751 RINF.ZIN	1,00000
34	11080000	ROS.PIANA D. 8 U6592 ZIN	21,00000
35	01014495	CHIUSURA ASOLA CARTER CINGHIE	1,00000
36	10117085	DADO IN GABBIA M8 PER LAMIERE SP. 1,8 - 3,2	2,00000
37	10117086	DADO IN GABBIA M8 PER LAMIERE SP. 3,3 - 4,7	2,00000
38	30027524	RONDELLA GUIDA MOLLA WGR	2,00000
39	30000860	MOLLA AMMORTIZZATORE SERIE AGRI ZINCATA	1,00000
40	30041371	REGISTRO GALOPPINO DYNAMIC	1,00000
41	11160000	ROS.PIANA D.16 U6592 ZIN	1,00000



Nr.	Codice Code	Descrizione Part	Quantità Quantity
42	10125164	DE NORM M 16 U5588 FE ZIN	2,00000
43	10100300	SEEGER E 30 U7435 NOR	2,00000
44	00011043	CUSCINETTO 6206 2RS1 FAG/SKF	2,00000
45	30031511	PULEGGIA GALOPPINO 4 GOLE SPB DP 110	1,00000
46	30040913	TIRANTE FILETTATO PER TENDICINGHIA L.340	1,00000
47	10114081	DA BASS.M 8 U7474 FE ZIN	8,00000
48	11116091	VTE 16X 35 U5739 8.8 ZIN	4,00000
49	11912081	VTBE 12X 30 I7380 10.9 ZIN	26,00000
50	11120000	ROS.PIANA D.12 U6592 ZIN	38,00000
51	30044308	GOMMA POSTERIORE SERIE 160	1,00000
52	000101485	VTE 8X 25 U 5739 8.8 ZN	6,00000
53	15173030	RONDELLA DI BLOCC. Ø17x30,7x3,4 NORD-LOCK NL16SP	4,00000
54	11112091	VTE 12X 35 U5739 8.8 ZIN	4,00000
55	01017802	PIASTRA FISSAGGIO SP. 10 IN FE 360	1,00000
56	10114121	DA BASS.M 12 U7474 FE ZIN	2,00000
57	11912061	VTBE 12X 20 I7380 10.9 ZIN	8,00000
58	12120000	ROS.GROW. D.12 U1751 RINF.ZIN	2,00000
59	30044317	PREMIGOMMA L=160	1,00000